



Outdoor



BARAZZA
taste of design



Outdoor



FREEDOM TURNS ON THE IMAGINATION.

The desire for freedom is the leitmotif of Barazza's Outdoor collection. The beautiful design teams up with the innovative features to give a truly unique experience. The collection has been designed to celebrate the feeling of independence in every one of us, offering us infinite possibilities to manage our time in new spaces. Far-reaching expanses of sun, sea and countryside become the backdrop for our most memorable moments, moments to be enjoyed without a care in the world, thanks to the hard-wearing AISI 316 stainless steel, a material that is beautiful to look at and withstands even the harshest weather.





40 cm Thalys freestanding gas hob with 4.7 kW burner code 1PTF1
40 cm Thalys freestanding barbecue hob code 1PTFBQ
40 cm Thalys freestanding teppanyaki hob code 1PTFTK
86x51 cm Lab 316 with lowering sink code 1LLB916
Mood Top mixer tap with remote control code 1RUBMDT

OUR DESIRE FOR ENDLESS NEW HORIZONS.

Nature is an incredible source of inspiration for our creativity and offers new entertaining opportunities, thanks to the Thalass hobs which take their name from Greek mythology and the goddess of the sea, the harbinger of fertility. The Thalass freestanding hobs are the focal point of the Outdoor collection; beautiful and resistant to the elements and the salty sea air, they can be positioned wherever you want, so you can try out your culinary skills using your favourite cooking techniques.



AISI 316 stainless steel, a hard-wearing and versatile material, is also used for the Lab 316 sink with lowering, built-in or undermounted. And to add to its versatility and practicality there is a new accessory, a sink grid in HPL that sits on the bottom of the bowl and provides a handy surface to wash vegetables on and protect the bottom of the sink.





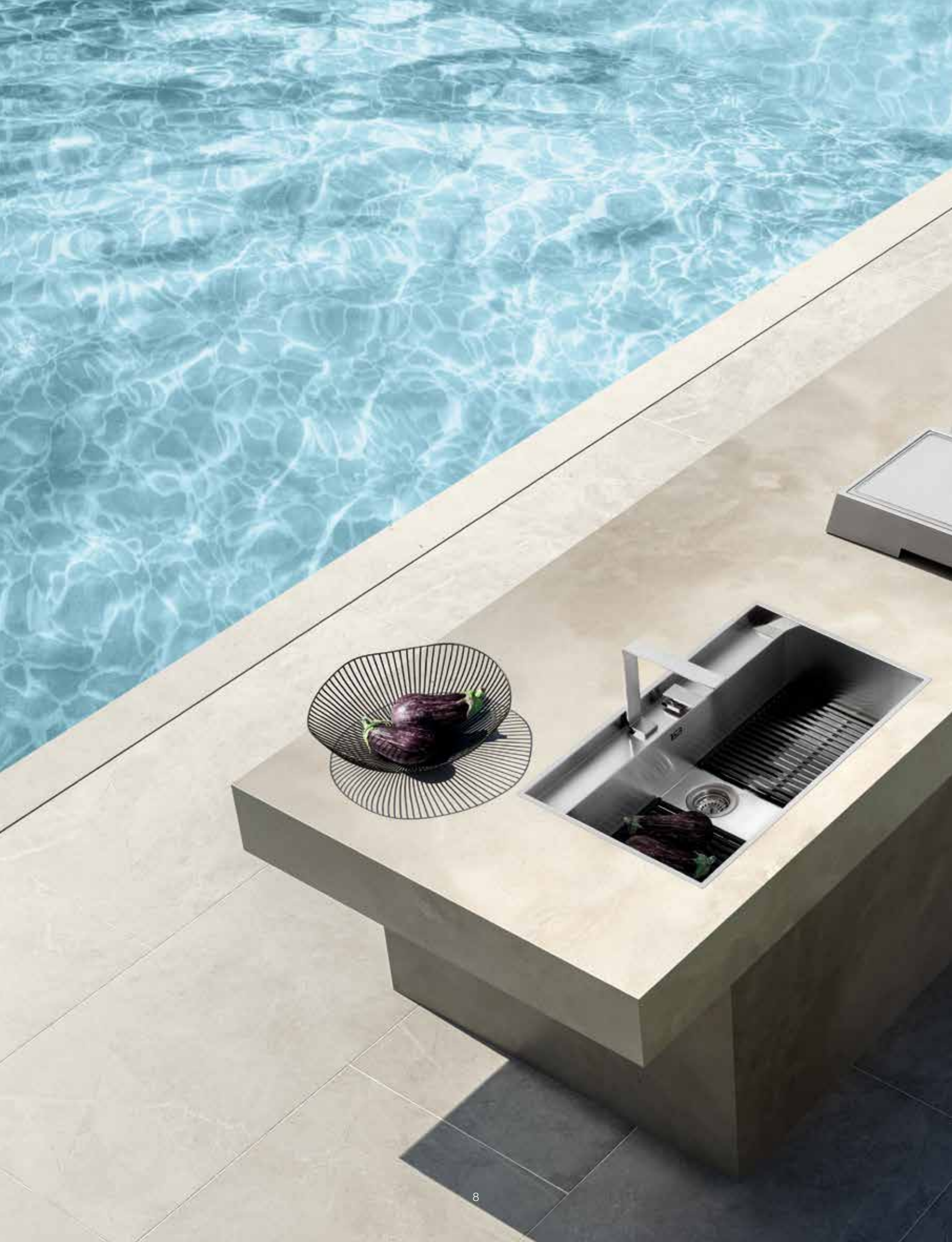



THE ESSENTIAL IS NOW VISIBLE.

The feeling of newfound freedom that the Outdoor collection conveys is captured in the practical multi-purpose Cover for the Thalys hobs. This accessory has three uses: it is a handy tray to carry food from the hob to the table, it protects the hobs when they are not being used and gives the space a cleaner aesthetic. This minimalism is further enhanced by the Lab Cover 316 sink with the Thalys telescopic mixer tap which vanishes under its practical cover.

40 cm Thalys freestanding barbecue hob code 1PTFBQ
40 cm Thalys freestanding teppanyaki hob code 1PTFTK
Thalys multipurpose cover code 1C306
57x51 cm Lab Cover 316 sink with Thalys telescopic mixer tap
with remote control code 1LLB606





The new Thalys telescopic mixer tap in AISI 316 stainless steel with remote control adds the perfect finishing touch to the Lab Cover 316 sink. Once it has been lowered, it can be housed under the cover to optimise space and leave the work surface uncluttered. The special B-shaped overflow is an exclusive detail found on all the AISI 316 stainless steel sinks and bowls in the Outdoor collection.



A NEW DIMENSION IN TIME AND SPACE.

There's more than one place where we feel really at home. The Thalys freestanding hobs offer endless possibilities for relaxing and connecting with family and friends.

Any place can become your new entertaining space because they are so easy to move and position wherever you want.



40 cm Thalys freestanding induction hob code 1PTFID
40 cm Thalys freestanding barbecue hob code 1PTFBQ
40 cm Thalys freestanding teppanyaki hob code 1PTFTK
2x Thalys multipurpose cover code 1C306





Even if they are not needed to protect the hobs from the elements, the multi-purpose Covers provide a handy surface to place things on and give the room a completely essential look.



**NOT ONLY PRACTICAL,
A STUDY IN BEAUTY.**

Even if you don't need to move your Thalass work surfaces from one area to another, you'll still love their compact design and outstanding resistance to the elements. The built-in version has the same features as the freestanding one and gives the worktop a great aesthetic appeal.





70x40 cm R. "12" 316 square bowl code 1QR706
Officina Shower 316 mixer tap code 1RUBOF316
Black HPL chopping board code 1TOF26N
Thalas multipurpose cover code 1C306
Thalas solid oak wood chopping board code 1TTH
37 cm Thalas built-in induction hob code 1PTIID
37 cm Thalas built-in teppanyaki hob code 1PTITK



The secret of a winning team is its members: the chopping board in solid oak provides an interesting textural contrast with the steel and is an exceptional, compact and very hard-wearing accessory. It fits perfectly into the inside of the Cover when it is used as a tray.







A NEW EVOLUTION OF THE SPECIES.

The elements in the Outdoor collection can be installed as built-in into custom worktops in AISI 316 stainless steel, exceeding even the most ambitious visions and taking style to the next level. Now is the time to indulge in your own truly unique and incredibly personal aesthetic.





270x80 cm AISI 316 stainless steel island with satin finish with 3 cm edge.
27 cm AISI 316 stainless steel upstand, customized doors, front coverings for drawers and shelves with satin finish. 50x40 cm R. "12" 316 welded square bowl.
Kit Top mixer tap with remote control and pull-out spray head code 1RUBMRKT.
37 cm Thalass teppanyaki hob installed built-in.
37 cm Thalass barbecue hob installed built-in.
37 cm Thalass gas hob with 4,7 kW burner installed built-in.
Thalass multipurpose cover code 1C306.



A figure emerges from the shadows: the hobs in the built-in version have a 3 cm raised edge around them, creating interesting geometrical contrasts with the worktop. The stainless steel used for the worktops, fronts, drawers, sides, shelves, sinks and integrated welded bowls can have a satin or Vintage finish, further enhancing the unique features of the Thalys hobs.



BEAUTY AND FUNCTION.

The sleek lines of the square sink with radius "12" and the practical Kit Top mixer tap with remote control and pull-out spray head complete the functional work surface, the perfect balance between design and practicality.





THALAS FREESTANDING HOBS

The Outdoor collection is a complete range of Thalass freestanding hobs which are easy to move and position and are suitable for different cooking and prepping techniques. The special chemical composition of the AISI 316 stainless steel used for the hobs gives them extra protection against corrosion caused by the salty sea air, so they can be used in any environment. The practical multi-purpose Cover adds the perfect finishing touch.

1 GAS



code 1PTF1
Page 34

2 GAS



code 1PTF2
Page 34

INDUCTION



code 1PTFID
Page 34

TEPPANYAKI



code 1PTFTK
Page 35

BARBECUE



code 1PTFBQ
Page 35

MULTIPURPOSE COVER



code 1C306
Page 35

THALAS BUILT-IN HOBS

Thalass built-in hobs can be installed on any work surface, either in stainless steel or other materials. It is a complete range suitable for different cooking and prepping techniques. The special chemical composition of the AISI 316 stainless steel of the hobs gives them extra protection against corrosion caused by the salty sea air, making them suitable for all environments.

1 GAS



code 1PTI1
Page 36

2 GAS



code 1PTI2
Page 36

INDUCTION



code 1PTIID
Page 36

TEPPANYAKI



code 1PTITK
Page 37

BARBECUE



code 1PTIBQ
Page 37

MULTIPURPOSE COVER



code 1C306
Page 37

316 SINKS AND SQUARE BOWLS

The sinks and square bowls in the Outdoor collection come in different sizes and installations, but their designs are all sleek and minimal and the special chemical composition of the AISI 316 stainless steel gives them extra protection against corrosion caused by the salty sea air.

LAB 316 SINK WITH LOWERING
57 X 51 CM



code 1LLB616
Page 39

LAB 316 SINK WITH LOWERING
86 X 51 CM



code 1LLB916
Page 39

LAB COVER 316 SINK
57 X 51 CM



code 1LLB606
Page 41

R."12" 316 SQUARE BOWL
40 X 40 CM



code 1QR406
Page 43

R."12" 316 SQUARE BOWL
50 X 40 CM



code 1QR506
Page 43

R."12" 316 SQUARE BOWL
70 X 40 CM



code 1QR706
Page 43

MIXER TAPS

A wide range of mixer taps in AISI 316 stainless steel, with different shapes and sizes, but they all make the sinks and square bowls they are fitted onto exceptionally functional and efficient.

OFFICINA SHOWER 316



code 1RUBOF316
Page 46

MOOD ONE



code 1RUBMD1
Page 46

THALAS TELESCOPIC



code 1RUBTH
Page 47

MOOD TOP



code 1RUBMDT
Page 47

KIT TOP



code 1RUBMRKT
Page 47



FREESTANDING AND BUILT-IN THALAS HOBS

Double ring 4.7 kW



A burner that guarantees high performance thanks to its high power. For greater precision, there are two knobs to control the 0.8 kW internal flame and the 3.9 kW external flame. Also suitable for cooking with a wok.

Chef double ring 3.5 kW



Thalas hobs with 2 gas burners are equipped with Chef double ring 3.5 kW that guarantees professional results, thanks to two flame rings that evenly distribute heat to the base of cooking instrument. The flame is directed so that it is concentrated on the centre of the burner, making cooking even more rapid.

Induction



Heat is only generated on the bottom of the pan and is transmitted directly to the food being cooked. At 90% efficiency, cooking times are shorter. The surface remains cool for greater safety and to make cleaning easier.

Barbecue



This electric barbecue made of lava stone absorbs fat and stops smoke from forming. The heating element is located under the grill to avoid contact with cooking liquids which could otherwise generate smoke. The quality of the cooking is just the same as with a traditional barbecue.

T Teppanyaki



AISI 304 stainless steel electric hotplate measuring 6 mm thick for cooking meat, fish and vegetables without adding seasoning. It is divided into two cooking zones that can be used individually or together, without mixing the flavours of the different dishes. It has a thermostat and is easy to clean. Use a small amount of sparkling water with washing-up liquid and a steel brush to clean.

Multi-purpose cover



The Thalas multi-purpose cover protects the hobs from the elements, acts as a cover and surface to place items on and can also be used as a tray to carry and serve food at the table. The solid oak wood chopping board is an excellent accessory and completes its functionality.

FREESTANDING THALAS HOBS

40 cm freestanding Thalass hob

double ring 4.7 kW



40 cm freestanding Thalass hob

1 gas burner + Chef double ring



40 cm freestanding Thalass hob

2 induction zones



Waterproof cover



Accessories: 34 35

- extra-thick AISI 316 stainless steel
- cast iron pan support and burner caps
- double control burner
- equipment: electronic activation with battery, safety valve, eco-flame
- predisposition for LPG supply
- waterproof cover

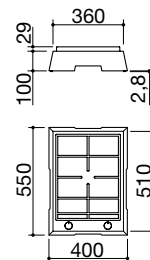

Burner power:

- 1 double ring: 4.7 kW (central 0.8 kW and ring 3.9 kW)

SATIN FINISH AISI 316 STAINLESS STEEL

code 1PTF1



- extra-thick AISI 316 stainless steel
- cast iron pan support and burner caps
- equipment: electronic activation with battery, safety valve, eco-flame,
- predisposition for LPG supply
- waterproof cover

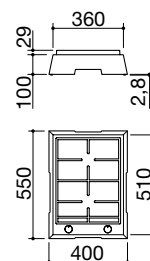

Burner power:

- 1 semi-rapid: 1.75 kW
- 1 Chef double ring: 3.5 kW

SATIN FINISH AISI 316 STAINLESS STEEL

code 1PTF2



- extra-thick AISI 316 stainless steel
- functions: power management, Booster, selective pan detection, progressive adjustment from 0 to 9, keep warm, automatic preheating, electronic child-safety lock, residual heat indicator, safety switch-off
- minimum pan diameter: \varnothing 110 mm
- adjustable power levels: 1.6 – 2.0 – 2.4 – 2.8 – 3.2 – 3.7 kW
- maximum absorbed power: 3.7 kW
- equipment: Schuko mains plug
- waterproof cover
- Thalass 1TTH chopping board

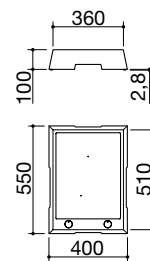

Induction zone power:

- 1 zone \varnothing 200 mm: 2.3-3 kW (*)
 - 1 zone \varnothing 160 mm: 1.4-2.1 kW (*)
- (*) with Booster function

SATIN FINISH AISI 316 STAINLESS STEEL

code 1PTFID

Accessories:

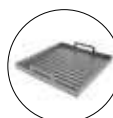

34

code 1BSIJ



35

code 1RWJ



73

code 1TTH

FREESTANDING THALAS HOBS

40 cm freestanding Thalass hob
teppanyaki



40 cm freestanding Thalass hob
barbecue



Thalass multipurpose cover
waterproof cover / serving tray



- extra-thick AISI 316 stainless steel
- AISI 304 stainless steel single hotplate, 6 mm thick
- thermostat
- 2 cooking zones
- electronic temperature control 0 °C to 250 °C
- hotplate activation indicator and thermostat
- maximum absorbed power: 3 kW
- equipment: Schuko mains plug
- waterproof cover
- Thalass 1TTH chopping board

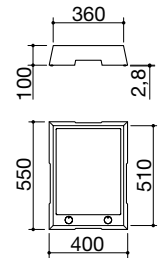

SATIN FINISH AISI 316 STAINLESS STEEL code 1PTFTK



- extra-thick AISI 316 stainless steel
- barbecue with electric element
- cast iron grid
- lava stone to absorb cooking liquids
- AISI 304 stainless steel removable tray
- progressive adjustment from 0 to 9
- heating element activation indicator
- maximum absorbed power: 2.4 kW
- equipment: Schuko mains plug
- waterproof cover

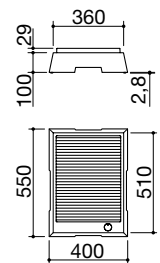

SATIN FINISH AISI 316 STAINLESS STEEL code 1PTFBQ

Accessories: 73

- extra-thick AISI 316 stainless steel
- dual function: cover and serving tray
- compatible with all freestanding and built-in Thalass hobs
- compatible with waterproof cover

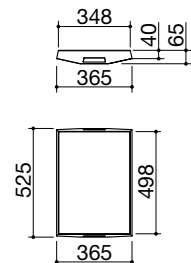

SATIN FINISH AISI 316 STAINLESS STEEL code 1C306



BUILT-IN THALAS HOBS

37 cm built-in Thalys hob double ring 4.7 kW



37 cm built-in Thalys hob 1 gas burner + Chef double ring



37 cm built-in Thalys hob 2 induction zones



Accessories: 34 35

- extra-thick AISI 316 stainless steel
- cast iron pan support and burner caps
- double control burner
- equipment: electronic activation with battery, safety valve, eco-flame, fixing clips, seal
- predisposition for LPG supply
- waterproof cover
- cut out: 34x49 cm

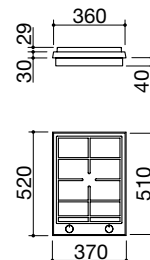

Burner power:

- 1 double ring: 4.7 kW
(central 0.8 kW and ring 3.9 kW)

SATIN FINISH AISI 316 STAINLESS STEEL code 1PTI1

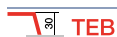

- extra-thick AISI 316 stainless steel
- cast iron pan support and burner caps
- equipment: electronic activation with battery, safety valve, eco-flame, fixing clips, seal
- predisposition for LPG supply
- waterproof cover
- cut out: 34x49 cm

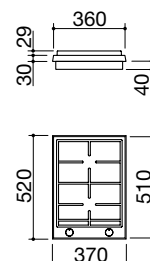

Burner power:

- 1 semi-rapid: 1.75 kW
- 1 Chef double ring: 3.5 kW

SATIN FINISH AISI 316 STAINLESS STEEL code 1PTI2



- extra-thick AISI 316 stainless steel
- functions: power management, Booster, selective pan detection, progressive adjustment from 0 to 9, keep warm, automatic preheating, electronic child-safety lock, residual heat indicator, safety switch-off
- minimum pan diameter: \varnothing 110 mm
- adjustable power levels: 1.6 – 2.0 – 2.4 – 2.8 – 3.2 – 3.7 kW
- maximum absorbed power: 3.7 kW
- equipment: Schuko mains plug, fixing clips, seal
- waterproof cover
- Thalys 1TTH chopping board
- cut out: 34x49 cm

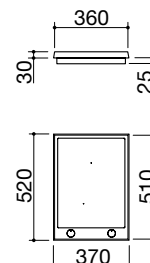

Induction zone power:

- 1 zone \varnothing 200 mm: 2.3-3 kW (*)
 - 1 zone \varnothing 160 mm: 1.4-2.1 kW (*)
- (*) with Booster function

SATIN FINISH AISI 316 STAINLESS STEEL code 1PTIID

Accessories:

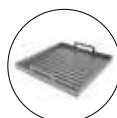

34

code 1BSIJ



35

code 1RWJ



73

code 1TTH

BUILT-IN THALAS HOBS

37 cm built-in Thalys hob
teppanyaki



37 cm built-in Thalys hob
barbecue



Thalys multipurpose cover
waterproof cover / serving tray



- extra-thick AISI 316 stainless steel
- AISI 304 stainless steel single hotplate, 6 mm thick
- thermostat
- 2 cooking zones
- electronic temperature control 0 °C to 250 °C
- hotplate activation indicator and thermostat
- maximum absorbed power: 3 kW
- equipment: Schuko mains plug, fixing clips, seal
- waterproof cover
- Thalys 1TTH chopping board
- cut out: 34x49 cm

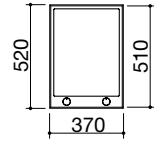
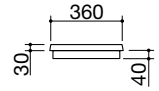

SATIN FINISH AISI 316 STAINLESS STEEL code 1PTITK



- extra-thick AISI 316 stainless steel
- barbecue with electric element
- cast iron grid
- lava stone to absorb cooking liquids
- AISI 304 stainless steel removable tray
- progressive adjustment from 0 to 9
- heating element activation indicator
- maximum absorbed power: 2.4 kW
- equipment: Schuko mains plug, fixing clips, seal
- waterproof cover
- cut out: 34x49 cm

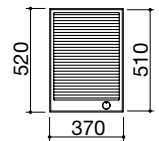
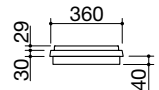

SATIN FINISH AISI 316 STAINLESS STEEL code 1PTIBQ

Accessories: 73

- extra-thick AISI 316 stainless steel
- dual function: cover and serving tray
- compatible with all freestanding and built-in Thalys hobs
- compatible with waterproof cover

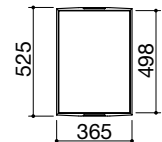
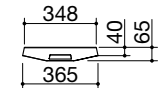

SATIN FINISH AISI 316 STAINLESS STEEL code 1C306





LAB 316 SINKS WITH LOWERING

flat edge built-in, flush and undermounted

57x51 cm built-in, flush and undermounted Lab 316 sink
1 bowl with lowering



86x51 cm built-in, flush and undermounted Lab 316 sink
1 bowl with lowering



FEB FT UM

Accessories: 6 19 71

- extra-thick AISI 316 stainless steel
- bowl radius "0"
- 54x38.8x18.3h cm bowl
- bowl with lowering for positioning and sliding of accessories
- equipment: 3½" basket strainer waste, pop-up plug, B overflow
- tap hole: 2 holes as standard
- base unit for bowls:
 - built-in and flush: 60 cm
 - undermounted: 80 cm
- cut out: 56x49 cm
- flush-top and undermounted: see website

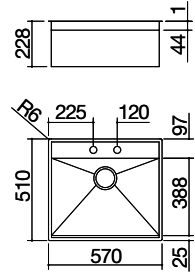

SATIN FINISH AISI 316 STAINLESS STEEL code 1LLB616

FEB FT UM

Accessories: 6 19 67 71

- extra-thick AISI 316 stainless steel
- bowl radius "0"
- 83x38.8x18.3h cm bowl
- bowl with lowering for positioning and sliding of accessories
- equipment: 3½" basket strainer waste, pop-up plug, B overflow
- tap hole: 2 holes as standard
- base unit for bowls:
 - built-in and flush: 90 cm
 - undermounted: 100 cm
- cut out: 85x49 cm
- flush-top and undermounted: see website

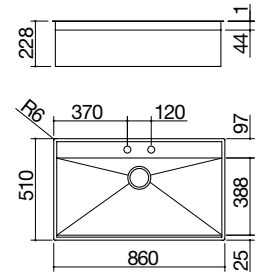

SATIN FINISH AISI 316 STAINLESS STEEL code 1LLB916

Accessories:

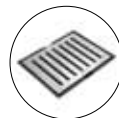

6 code 1TBF

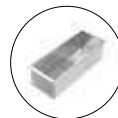

19 code 1VBF

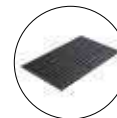

67 code 1GQN

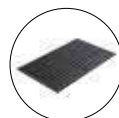

71 code 1GQRN

Standard equipment:

fixing clips, space-saver trap with dishwasher connection, cardboard packaging.





LAB COVER 316 SINKS

flat edge built-in and flush

57x51 cm built-in and flush Lab Cover 316 sink
1 bowl with cover + tap



FEB FT

Accessories: 71

- extra-thick AISI 316 stainless steel
- bowl radius "0"
- 54x34x18.3h cm bowl
- balanced, removable, AISI 316 stainless steel cover with manual opening
- equipment: 3½" basket strainer waste, B overflow, Thalys telescopic mixer tap with remote control 1RUBTH
- tap hole: 2 holes as standard
- base unit for bowls: 60 cm
- cut out: 56x49 cm
- flush-top: see website

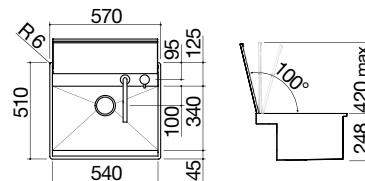

SATIN FINISH AISI 316 STAINLESS STEEL code 1LLB606

Accessories:



71
code 1GQRN

Standard equipment:
fixing clips, space-saver trap with dishwasher connection, cardboard packaging.





R. "12" 316 SQUARE BOWLS flat edge built-in, flush and undermounted

40x40 cm R. "12" 316 square bowl
flat edge built-in, flush and undermounted



50x40 cm R. "12" 316 square bowl
flat edge built-in, flush and undermounted



70x40 cm R. "12" 316 square bowl
flat edge built-in, flush and undermounted



FEB FT UM

Accessories: 8 17 20 25 40 43
45 61 62 66 71 72

- extra-thick AISI 316 stainless steel
- bowl radius "12"
- 40x40x20h cm bowl
- equipment: 3½" basket strainer waste, B overflow
- base unit for bowls:
 - built-in and flush: 50 cm
 - undermounted: 60 cm
- cut out: 42x42 cm
+ notch for overflow
flush-top and undermounted: see website

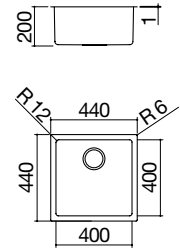

SATIN FINISH AISI 316 STAINLESS STEEL code 1QR406

FEB FT UM

Accessories: 8 17 20 25 40 43
45 61 62 66 71 72

- extra-thick AISI 316 stainless steel
- bowl radius "12"
- 50x40x20h cm bowl
- equipment: 3½" basket strainer waste, B overflow
- base unit for bowls:
 - built-in and flush: 60 cm
 - undermounted: 80 cm
- cut out: 52x42 cm
+ notch for overflow
flush-top and undermounted: see website

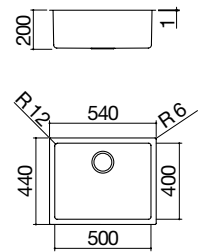

SATIN FINISH AISI 316 STAINLESS STEEL code 1QR506

FEB FT UM

Accessories: 8 17 20 25 40 43
45 61 62 66 71 72

- extra-thick AISI 316 stainless steel
- bowl radius "12"
- 70x40x20h cm bowl
- equipment: 3½" basket strainer waste, B overflow
- base unit for bowls:
 - built-in and flush: 80 cm
 - undermounted: 90 cm
- cut out: 72x42 cm
+ notch for overflow
flush-top and undermounted: see website

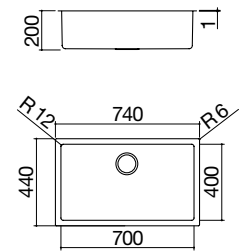

SATIN FINISH AISI 316 STAINLESS STEEL code 1QR706

Accessories:

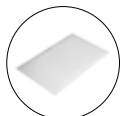

8
code 1TOF26



17
code 1VOF



20
code 1VSOF



25
code 1CIVQ

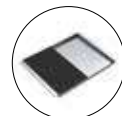

40
code 1CITN



43
code 1TOF26N



45
code 1GSPA



61
code 1CIFX

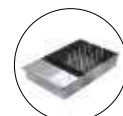

62
code 1VSFX

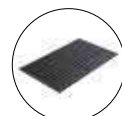

66
code 1GLN



71
code 1GQRN



72
code 1SPX

Standard equipment:

fixing clips, space-saver trap with dishwasher connection, cardboard packaging.





OUTDOOR MADE TO MEASURE

Barazza outdoor products in AISI 316 stainless steel can be integrated into exclusive custom-made worktops in stainless steel with satin or Vintage finish, for unique tailoring solutions that can be customized at will.

Guidelines for outdoor Made to Measure worktops:

Finishes

The worktops in AISI 316 stainless steel are available in the refined and elegant satin finish or in the Vintage finish, in which the material comes to life thanks to a particular manual surface processing that makes each piece unique and unrepeatable.

Dimensional limits

All worktops are customizable in length, depth and thickness. The maximum sheet size for AISI 316 stainless steel worktops with satin and Vintage finish is 4200x1250 mm. Theoretical development is calculated like this:
worktop length / depth + 2x thickness + lower folds.

Worktop depth

Wall worktops are available with a depth between 300 and 750 mm, Island worktops are available with a depth between 751 and 1200 mm; if the worktop depth exceeds 1000 mm, only 6, 8 or 12 mm thick edges can be used.

Available edge thicknesses

6 - 8 - 12 - 20 - 30 - 40 - 60 mm

Worktop reinforcement panels

All the worktops are equipped with an internal aluminum support that gives greater strength to the product and better resistance to external agents.

Joints

If a worktop has dimensions that exceed the indicated dimensional limits, it is possible to combine two or more worktops at 45° or 90°, in an "L" shape or in line. Worktops with 40 and 60 mm thickness will be equipped with a junction system.

Cooking

On the AISI 316 stainless steel worktops it is possible to install, exclusively built-in, all the Thalys hobs (in satin finish).

Washing

On the AISI 316 stainless steel worktops it is possible to weld the R. "0" sinks with lowering, the R. "0" sinks with cover and the R. "12" square bowls, either in satin or Vintage finish.

Other workings

In AISI 316 stainless steel it is also possible to make splash backs, upstands, sides, doors and shelves.



SATIN FINISH STAINLESS STEEL



VINTAGE STAINLESS STEEL

MIXER TAPS with single lever

Officina shower 316 mixer tap
with pull-out spray head



- AISI 316 stainless steel
- pull-out spray head
- ceramic disc cartridge
- tap rotation: 360°
- tap base: Ø 45 mm
- tap hole: Ø 35 mm

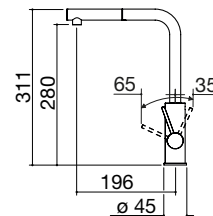

SATIN FINISH AISI 316 STAINLESS STEEL code 1RUBOF316

Mood One mixer tap



- AISI 316 stainless steel
- ceramic disc cartridge
- tap rotation: 360°
- tap base: 45x45 mm
- tap hole: Ø 35 mm

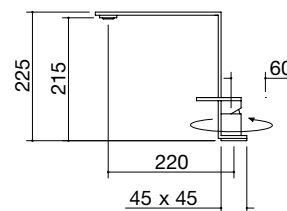

SATIN FINISH AISI 316 STAINLESS STEEL code 1RUBMD1



MIXER TAPS with remote control

Telescopic Thalys mixer tap with remote control



- AISI 316 stainless steel
- ceramic disc cartridge
- tap rotation: 360°
- tap base: Ø 55 mm
- control base: Ø 43 mm
- tap hole: Ø 35 mm
- control hole: Ø 35 mm

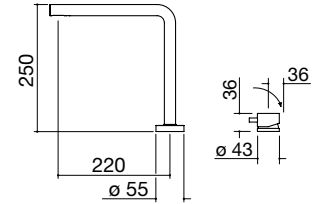

SATIN FINISH AISI 316 STAINLESS STEEL code 1RUBTH

Mood Top mixer tap with remote control

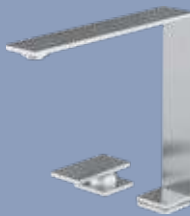

- AISI 316 stainless steel
- ceramic disc cartridge
- tap rotation: 360°
- tap base: 45x45 mm
- control base: 50x50 mm
- tap hole: Ø 35 mm
- control hole: Ø 35 mm

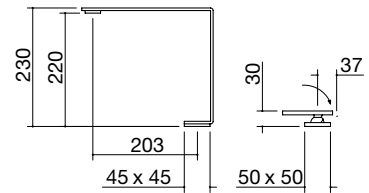

SATIN FINISH AISI 316 STAINLESS STEEL code 1RUBMDT

Kit Top mixer tap with remote control and pull-out spray head



- AISI 316 stainless steel
- ceramic disc cartridge
- tap rotation: 360°
- tap base: Ø 50 mm
- control base: Ø 50 mm
- spray-head base: Ø 55 mm
- tap hole: Ø 35 mm
- control hole: Ø 35 mm
- spray-head hole: Ø 35 mm

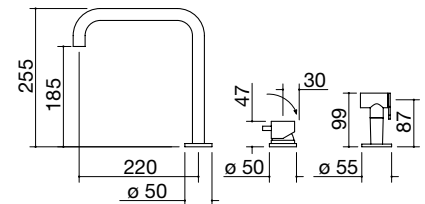

SATIN FINISH AISI 316 STAINLESS STEEL code 1RUBMRKT



SINK AND BOWL ACCESSORIES

B_Free multipurpose chopping board in AISI 304 stainless steel and black HPL



6 chopping board dimensions 33x41 cm code 1TBF

AISI 304 stainless steel colander



17 colander dimensions 15x43x12h cm code 1VOF

19 colander dimensions 15x41x12h cm code 1VBF

AISI 304 stainless steel perforated bowl cover



25 bowl cover dimensions 25x43 cm code 1CIVQ

Polyethylene chopping board



8 chopping board dimensions 26x43 cm code 1TOF26

AISI 304 stainless steel colander with draining rack



20 colander dimensions 25x43x7h cm code 1VSOF

AISI 304 stainless steel bowl cover with black HPL chopping board



40 bowl cover dimensions 25x43 cm code 1CITN



SINK AND BOWL ACCESSORIES

Black HPL chopping board



43 chopping board dimensions 26x43 cm code 1TOF26N

Roll-Up multipurpose stainless steel rack



45 rack dimensions 46x44 cm code 1GSPA

AISI 304 stainless steel bowl cover with black HPL draining rack



61 bowl cover dimensions 25x43 cm code 1CIFX

AISI 304 stainless steel colander with black HPL draining rack



62 colander dimensions 25x43x7h cm code 1VSFX

Black HPL rack



66 rack dimensions 26.5x43 cm code 1GLN

67 rack dimensions 26.5x48 cm code 1GQN

Black HPL grid for bowl bottom



71 grid dimensions 33.8x38.3 cm code 1GQRN



SINK AND BOWL ACCESSORIES

Thalas pop-up plug kit



72 with 3½" basket strainer waste and overflow hole code 1SPX



ACCESSORIES HOBS

AISI 304 stainless steel grill



34 grill dimensions 27x26 cm code 1BSIJ

Cast iron wok adapter



35 for double rings code 1RWJ

Thalas solid oak wood chopping board



73 chopping board dimensions 25x35.9 cm code 1TTH



CLEANING PRODUCTS

Easy Clean professional cleaning cream



-
- professional stainless steel cleaning cream
 - clean, polish and protect stainless steel
 - eco formula
 - 150 g each

pack of 3

code 1ECO3

pack of 12

code 1ECO12

Multi Clean professional multipurpose detergent



-
- professional multipurpose cleaner, suitable for daily cleaning
 - quickly remove dirt on all washable hard surfaces
 - eco formula
 - 200 ml each

pack of 3

code 1MC3

pack of 12

code 1MC12

Easy Clean professional microfibre cloth



-
- antibacterial
 - clean and sanitize any surface without using a detergent
 - dimensions: 40x40 cm

1 piece

code 1PMA

pack of 3

code 1PMA3

Cleaning box



Professional Cleaning Box kit contains:

- 1x Easy Clean 150 g
- 1x Multi Clean 200 ml
- 1x Easy Clean microfibre cloth

1 piece

code 1CBK

ICON KEY

AISI 316 STAINLESS STEEL	CHEF BURNER 3.5 KW	BOOSTER	ERGONOMIC GRIP	TAPS
EXTRA-THICK STAINLESS STEEL	ECO-FLAME	SELECTIVE PAN DETECTION	SINKS	
HOBS	ELECTRONIC ACTIVATION WITH BATTERY	KEEP WARM	BOWL RADIUS "0"	TELESCOPIC TAP
MODULE WIDTH	TEPPANYAKI	AUTOMATIC PREHEATING	BOWL RADIUS "12"	REMOTE CONTROL
STAINLESS STEEL KNOBS	BARBECUE	ELECTRONIC CHILD-SAFETY LOCK	LARGE BOWLS	PULL-OUT SPRAY HEAD
CAST IRON PAN SUPPORT	INDUCTION	RESIDUAL HEAT INDICATOR	POP-UP PLUG	PULL-OUT SPRAY HEAD
BURNER 4.7 KW	POWER MANAGEMENT	SAFETY SWITCH-OFF	BALANCED STAINLESS STEEL COVER	

INSTALLATION KEY



FREESTANDING THALAS



THALAS EDGE BUILT-IN



FLAT EDGE BUILT-IN



FLUSH-TOP



UNDERMOUNTED

WEIGHTS AND VOLUMES

PRODUCT CODE	PAGE	PACKAGING DIMENSIONS (cm)	VOLUME (m³)	WEIGHT (kg)
1C306	35/37	57x75x18	0.08	6
1LLB606	41	66x61x31	0.12	19.5
1LLB616	39	66x61x31	0.12	8.5
1LLB916	39	95x61x31	0.18	12.5
1PTF1	34	57x75x18	0.08	12
1PTF2	34	57x75x18	0.08	12
1PTFID	34	57x75x18	0.08	12
1PTFBQ	35	57x75x18	0.08	18
1PTFTK	35	57x75x18	0.08	18
1PTI1	36	57x75x18	0.08	11
1PTI2	36	57x75x18	0.08	11
1PTIID	36	57x75x18	0.08	11
1PTIBQ	37	57x75x18	0.08	17
1PTITK	37	57x75x18	0.08	17
1QR406	43	49.5x49.5x27	0.07	6.5
1QR506	43	59.5x49.5x27	0.08	8.5
1QR706	43	79.5x49.5x27	0.11	10.5
1RUBMD1	46	31x48x9	0.01	2.9
1RUBMDT	47	31x48x10	0.01	2.7
1RUBMRKT	47	30x56x7	0.01	2.7
1RUBOF316	46	30x56x7	0.01	2.5
1RUBTH	47	30x56x7	0.01	3

WARRANTY

Barazza appliances comply with EEC directives and are guaranteed in Italy for 2 years.

CERTIFICATIONS

In addition to the UNI EN ISO 9001 certification, which guarantees quality control and optimisation of production processes, and has customer satisfaction as its primary objective, Barazza also complies with UNI EN ISO 14001. The aim is to maintain and improve its environmental system. This includes managing the impact of its activities in an effective and eco-sustainable manner, optimising natural resources, as well as energy resources, and implementing regular control systems for waste disposal and preventing environmental pollution.



GENERAL NOTES

Barazza reserves the right to make any changes it deems necessary to improve its products at any time and without prior warning. The colours shown are by way of example only. Full or partial reproduction of this catalogue for commercial purposes, without specific authorisation from Barazza, is strictly forbidden.

BARAZZA
taste of design

Barazza srl

31025 Sarano di S. Lucia di Piave (TV) ITALIA

Via Risorgimento, 14

Tel. +39 0438 62888 - Fax +39 0438 64901

info@barazzasrl.it - www.barazzasrl.it

