

1X70V

DESCRIZIONE Vasca quadra raggio "15" vintage incasso filo e sottotop da 71x40 cm
DESCRIPTION 71x40cm built-in flush and undermount vintage square bowl with radius "15"

PESO LORDO 8.2 KG
GROSS WEIGHT

DIMENSIONI IMBALLO 795x495x270 mm
PACKAGING DIMENSIONS



! E' NECESSARIO FARE UNO SCANSO NEL TOP IN CORRISPONDENZA DEL TROPPOPIENO
YOU SHOULD MAKE A SLOT IN THE TOP WHERE THE OVERFLOW IS INSTALLED

- Acciaio inox AISI 304 di spessore elevato (*AISI 304 extra thick stainless steel*)
- Dimensione vasca: 71x40x19,5 h (*Bowl dimensions: 71x40x19,5 h cm bowl*)
- Dotazioni: pilettona 3"1/2, troppo-pieno con scarico perimetrale (*Equipment: 3.5" basket strainer waste, perimeter overflow*) **(A)**
- Base per inserimento vasca: (*Base unit for bowl:*)
 Sottotop(Undermount): 90 - Incasso Filo (built-in flush): 80
- Sottotop: 70.6x39.6 cm (*Undermounted: 70,6x39,6 cm*)
- Incasso: 73x42 cm (*Built-in: 73x42 cm*)
- Filo: 75.3x44.3 cm (*Flush: 75.3x44.3 cm*)

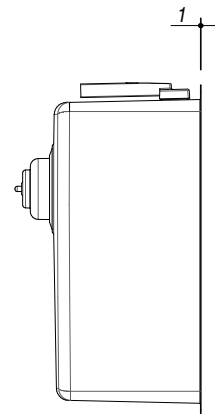
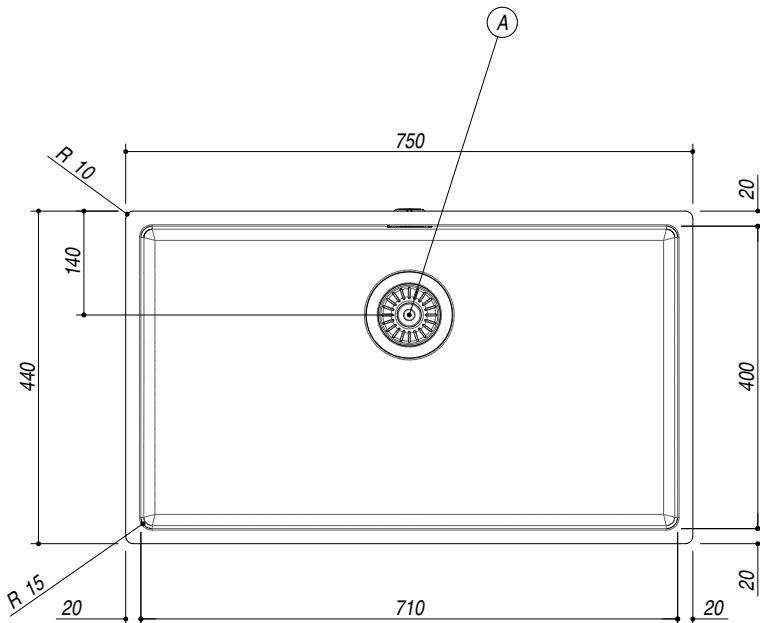
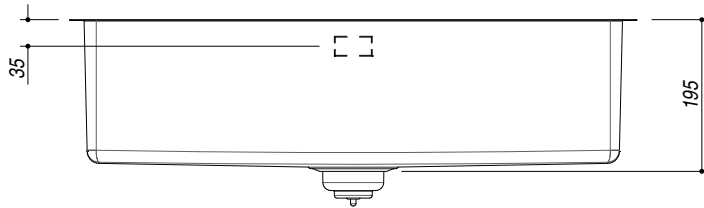

SCALA DISEGNO 1:10
DRAWING SCALE



TUTTE LE MISURE IN mm
ALL MEASURES IN mm

TOLLERANZA LINEARE: ± 0.5 mm
LINEAR TOLLERANCE

TOLLERANZA ANGOLARE: ± 0.2 °
ANGULAR TOLLERANCE

FORATURA PER INSTALLAZIONE INCASSO
BUILT-IN CUTOUT FOR TOP

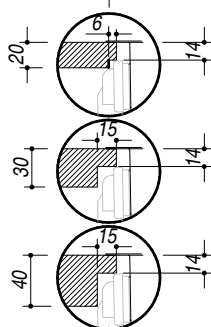
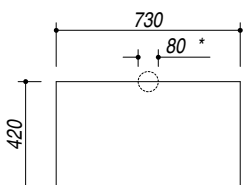

1:30

FORATURA PER INSTALLAZIONE A FILO
FLUSH CUTOUT FOR TOP

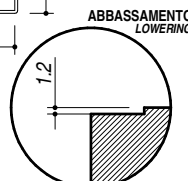
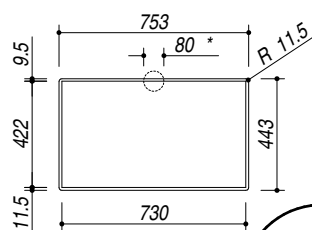

FORATURA PER INSTALLAZIONE SOTTOTOP
UNDERMOUNT CUTOUT FOR TOP

