

## 1VSVQ

**DESCRIZIONE** Vassoio forato con scolapiatti nero  
**DESCRIPTION** Stainless steel colander with draining-rack

**PESO LORDO** 2.2 kg **DIMENSIONI IMBALLO** 505x285x80 mm  
**GROSS WEIGHT** **PACKAGING DIMENSIONS**

**ACCIAIO INOX** HPL NERO  
**Stainless steel** **Black HPL**

**(A) SCOLAPIATTI REMOVIBILE REMOVABLE DRAINER**

- Per Lavelli Lab con 2 Vasche 1 vasca + gocci., 2 vasche +gocc. e Vasche quadre Flexi  
 (For Lab sinks with 2 bowls, 1 bowl + drainer, 2 bowls + drainer and Flexi Square bowls)

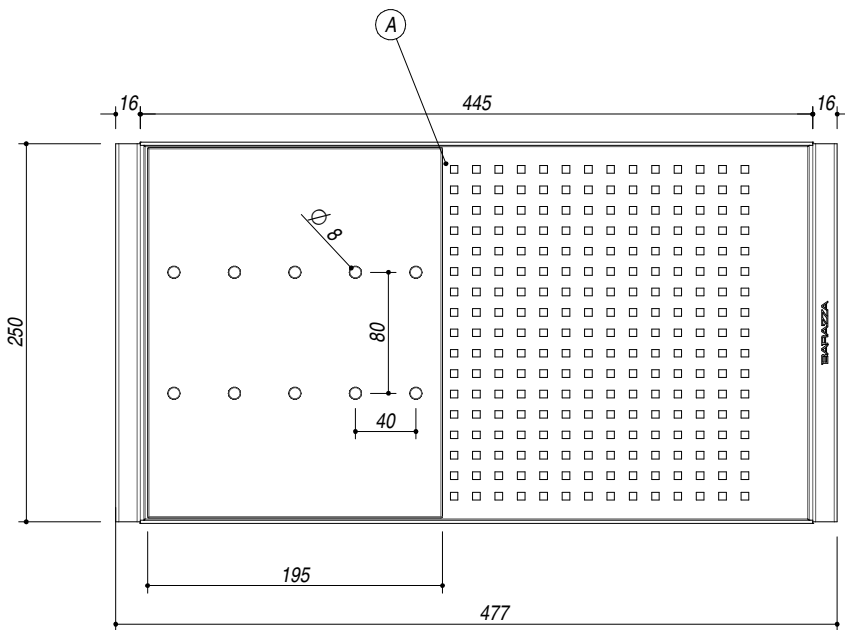
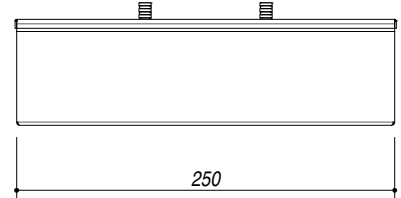
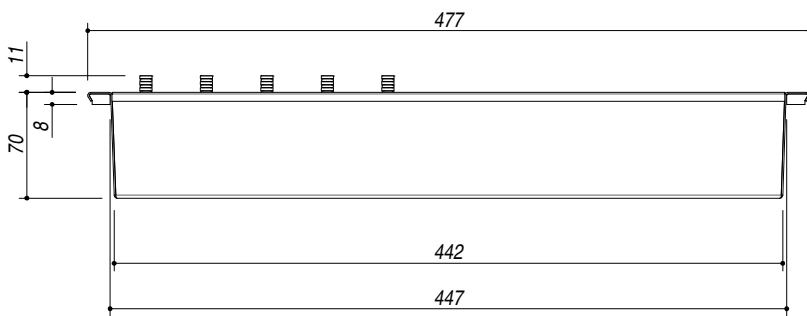
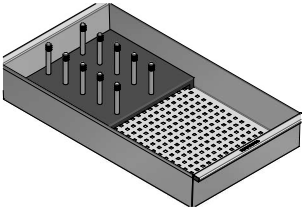

**SCALA DISEGNO** 1:5  
**DRAWING SCALE**



**TUTTE LE MISURE IN mm**  
**ALL MEASURES IN mm**

**TOLLERANZA LINEARE: ± 0.5 mm**  
**LINEAR TOLERANCE**

**TOLLERANZA ANGOLARE: ± 0.2 °**  
**ANGULAR TOLERANCE**

PER QUALSIASI CONTESTAZIONE SI FARA' RIFERIMENTO ESCLUSIVAMENTE A QUESTO DISEGNO  
 For any dispute the company will refer exclusively to this drawing

**BARAZZA** Barazza s.r.l. - Via Risorgimento, 14 - 31025 Sarano di S.Lucia di P. (TV) Italy  
 Tel. +39/0438/62888 - Fax +39/0438/64901 - info@barazzasrl.it - www.barazzasrl.it  
 Documento di proprietà aziendale. La Società tutelerà i propri diritti a termini di legge.

