

1IS9060/1D

DESCRIZIONE Lavello SELECT incasso 86x50 - 1 vasca + piano d'appoggio destro
DESCRIPTION 86x50 cm SELECT built-in sink - 1 bowl + right side supporting surface

PESO LORDO 7.1 kg **DIMENSIONI IMBALLO** 910x530x220 mm
GROSS WEIGHT **PACKAGING DIMENSIONS**

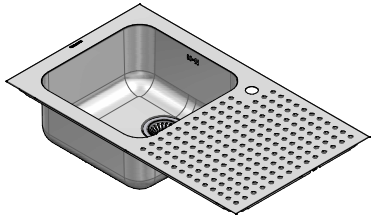

- Acciaio Inox AISI 304 di spessore elevato (*Extra thick stainless steel AISI 304*)
- Dimensioni vasche: 40x40x20 h cm (*Bowls dimensions: 40x40x20 h cm*)
- Dotazioni: pilettoni 3"1/2, foro troppo-pieno, (A)
(Equipment: 3"1/2 basket strainer waste, overflow)
- Foro rubinetto: 1 foro di serie, (*Mixer Tap Hole: 1 series hole*) (B)
- Base inserimento vasca: 60 (*Base unit for bowl: 60*)
- Incasso: 84x48 cm (*built-in: 84x48 cm*)

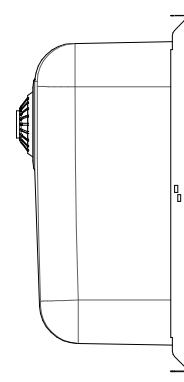
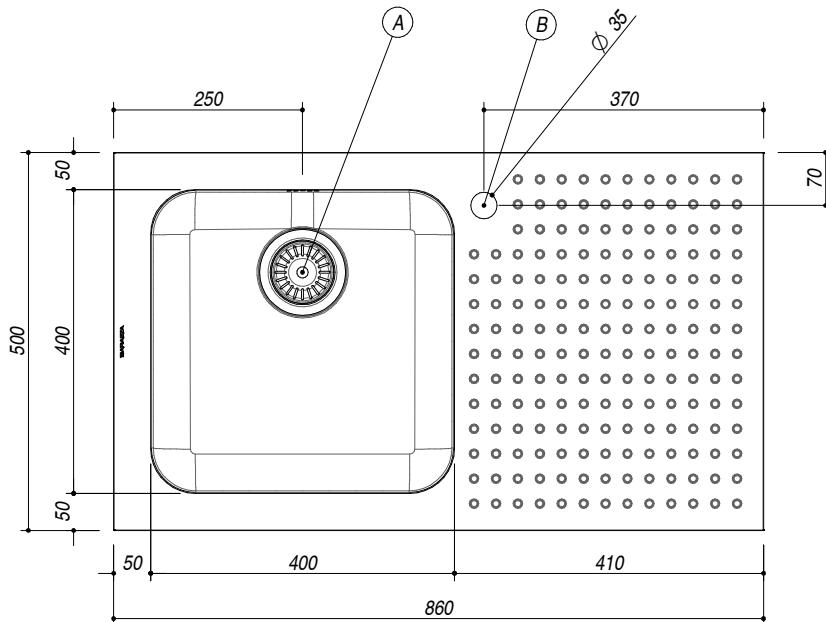
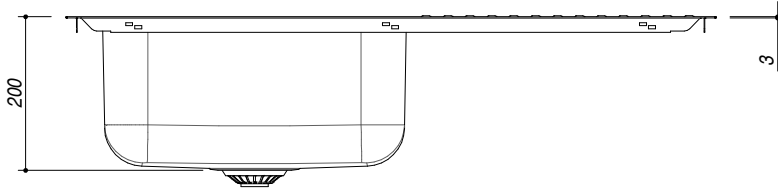

SCALA DISEGNO 1:10

TUTTE LE MISURE IN mm
ALL MEASURES IN mm

TOLLERANZA LINEARE: ± 0.5 mm
LINEAR TOLERANCE

TOLLERANZA ANGOLARE: ± 0.2 °
ANGULAR TOLERANCE

FORATURA PER INSTALLAZIONE AD INCASSO
BUILT-IN CUTOUT FOR TOP

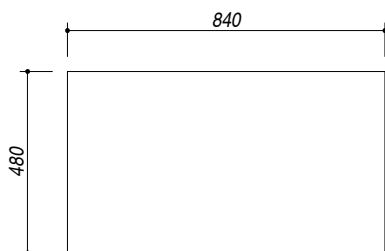

1:20