

**1CI33**

**DESCRIZIONE** Coprivasca in acciaio inox  
**DESCRIPTION** Stainless Steel bowl cover

**PESO LORDO** 0.8 kg  
**GROSS WEIGHT**

**DIMENSIONI IMBALLO** 350x340x20  
**PACKAGING DIMENSIONS**

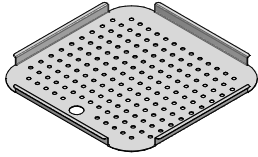

**ACCIAIO INOX**  
**Stainless steel**

- Quadrato per lavelli con vasca 33x33 (Rectangular for sinks with 33x33 bowl)

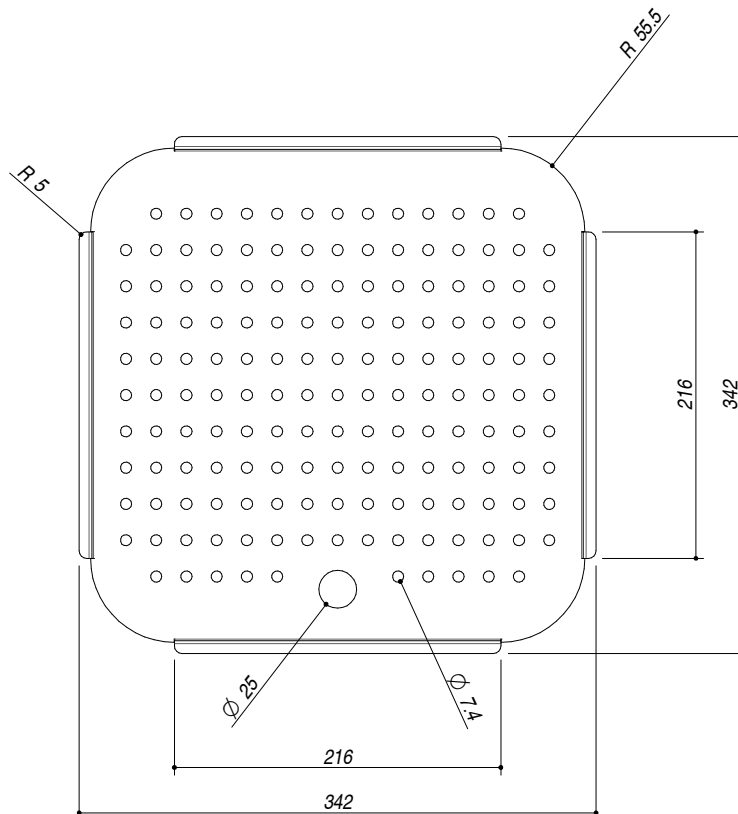
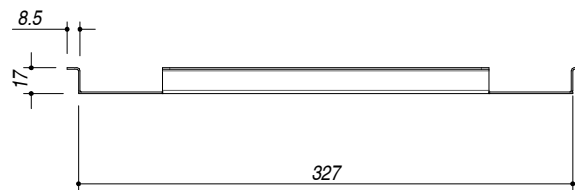

**SCALA DISEGNO** 1:5  
**DRAWING SCALE**



**TUTTE LE MISURE IN mm**  
**ALL MEASURES IN mm**

**TOLLERANZA LINEARE: ± 0.5 mm**  
**LINEAR TOLERANCE**

**TOLLERANZA ANGOLARE: ± 0.2 °**  
**ANGULAR TOLERANCE**

PER QUALSIASI CONTESTAZIONE SI FARA' RIFERIMENTO ESCLUSIVAMENTE A QUESTO DISEGNO  
 For any dispute the company will refer exclusively to this drawing

**BARAZZA** Barazza s.r.l. - Via Risorgimento, 14 - 31025 Sarano dS. Lucia di P. (TV) Italy  
 Tel. +39/0438/62888 - Fax +39/0438/64901 info@barazzasrl.it - www.barazzasrl.it  
 Documento di proprietà aziendale. La Società tutelerà i propri diritti a termini di legge.

