

MOOD FUSION

Mood Fusion is a single, built-in, steel surface that includes all functions in an authentic design space, with highly distinctive features: 4 mm thick steel, Flat Eco-design burners, Soft-Touch pan supports and a draining board. Real substance, in three Barazza steel finishes: satin, vintage and matt, for a highly customised look even for the material itself.



Examples of Mood Fusion depth 51



Examples of Mood Fusion depth 45



Suggested combinations:

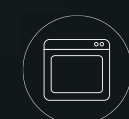

Feel page 138
Velvet page 176
Lab page 184



Mood One page 371
Mood Two page 371
Mood Top page 388
Soul page 389

Mood Fusion Vintage

A Fusion work surface offers everything you need; here, the beauty of the shapes and forms becomes a tool for a perfect performance in the kitchen. The special Vintage finish, obtained by hand thanks to the skilled craftsmen at Barazza, creates a highly textured, soft, warm surface. This 'worn' look has real character: the enjoyment of cooking is visible to the naked eye.

Suggested combinations:



Unique page 108
Velvet Vintage page 182



Mood One page 371
Mood Two page 371
Steel Shower Vintage page 380
Unique One page 383
Unique Two page 383
Unique Two Shower page 383
Mood Top page 388
Soul page 389



MOOD FUSION features

1 Built-in installation

The customised worktop surface can be built-in with a 4 mm edge.

2 Soft-Touch pan supports

The new cast iron Soft-Touch pan supports are pleasant to touch, more resistant and offer a real advantage as they can be dishwashed.

SOFT TOUCH

3 Sliding chopping board



The black HPL sliding chopping board allows you to optimise the full work surface, moving the ingredients around according to the required preparation.

4 Supporting surface with grooves



The supporting surface features grooves along the surface which extend beyond the edge as it meets the bowl, opening up a new channel for the water to flow down.

Mood Fusion Configurator



The Mood Fusion configurator, available online at www.barazzasrl.it, can be used to create your own work surface, with a choice of different hobs and sinks available.



MOOD FUSION features

Finish

- 4 mm solid stainless steel AISI 304 with satin finish. Available in the vintage or mat finish on request.

Dimension limits

- Maximum length: 236 cm
- Depth: 51 and 45 cm
- Worktop thickness: 0.4 cm
- Overall gas hob height: 4 cm
- Overall induction hob height: 6 cm
- Overall bowl height: 20 cm
- Overall worktop height: 2 cm
- Outer edge radius: 0.6 cm

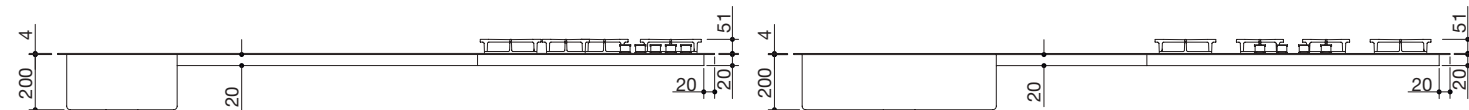

- Minimum distance between hob, bowl or draining board: 15 cm
- Minimum distance between two bowls: 6.4 cm
- Fixed distance between the centre of the tap hole and the bowl back edge: 4.5 cm
- Two back holes for tap and standard pop-up plug

Depth 51 cm

- Minimum distance between front edge and induction hob: 5.5 cm
- Minimum distance between side edge and induction hob: 3.5 cm
- Minimum distance between side edge and bowl: 3.4 cm
- Fixed distance from front edge to bowl: 3.4 cm
- Fixed distance from back edge to bowl: 8 cm
- Fixed distance between two tap holes: 12 cm
- Fixed length of supporting surface: 39.6 cm
- Two back holes for tap and standard pop-up plug

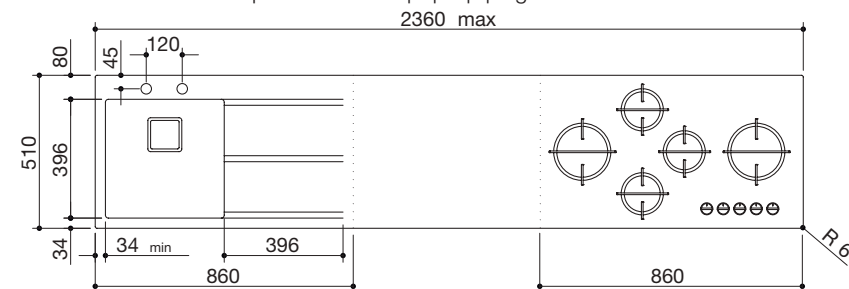

Dimensions for cut out

- Depth: 49 cm
- Length: -2 cm of surface dimensions

For Mood Fusion stainless steel worktop longer than 120 cm and 180 cm, Barazza recommends to consider to make two or three cut out holes respectively at a distance of 10 cm.

Depth 45 cm

- Minimum distance between side edge and bowl: 3.4 cm
- Fixed distance from front edge to bowl: 3.4 cm
- Fixed distance from back edge to bowl: 8 cm
- Fixed distance between two tap holes: 12 cm
- Fixed length of supporting surface: 39.6 cm
- Two back holes for tap and standard pop-up plug

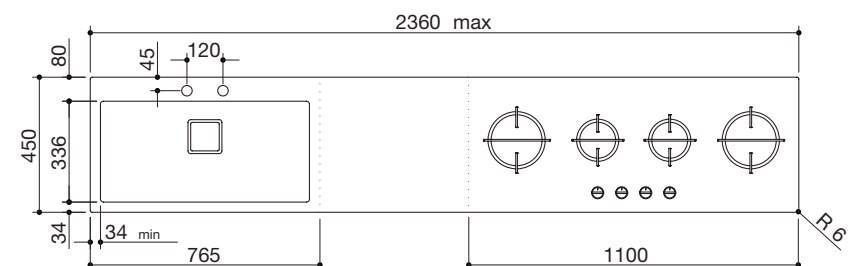

Dimensions for cut out

- Depth: 43 cm
- Length: -2 cm of surface dimensions

For Mood Fusion stainless steel worktop longer than 120 cm and 180 cm, Barazza recommends to consider to make two or three cut out holes respectively at a distance of 10 cm.

During the design stage, check the size of the units (hob, sink, tap) in the base units below.

MOOD FUSION products

Hobs for Mood Fusion depth 51

NEW

65 cm Mood

3 gas burners + 1 Flat Eco-design double ring
(hob length 65)



code **PM64**

75 cm Mood

4 gas burners + 1 Flat Eco-design double ring
(hob length 75)



code **PM75**

90 cm Mood

4 gas burners + 1 Flat Eco-design double ring
(hob length 86)



code **PM95**

90 cm induction

3 Touch Control zones
(hob length 81.5)



code **PDM93**

120 cm induction

4 Touch Control zones
(hob length 109.5)



code **PDM124**

Hobs for Mood Fusion depth 45

NEW

110 cm Mood

3 gas burners + 1 Flat Eco-design double ring
(hob length 110)



code **PM104**

MOOD FUSION products

Square bowls R. "12" for Mood Fusion depth 51

NEW

Accessories: 8 17 20 25 39 40 43 45 46

34x40x20 h



code **VQRM34**

40x40x20 h



code **VQRM40**

50x40x20 h



code **VQRM50**

70x40x20 h



code **VQRM70**

2 bowls measuring 34x40 only can be inserted

Square bowls R. "12" for Mood Fusion depth 45

NEW

50x34x20 h



code **VQRM5034**

70x34x20 h



code **VQRM7034**

2 bowls cannot be inserted

Workings for depth 51:

- Stainless steel worktop surface less than or equal to 150 including working costs code **LMF1**
- Stainless steel worktop surface more than 150 up to 190 including working costs code **LMF2**
- Stainless steel worktop surface more than 190 up to 236 including working costs code **LMF3**
- Supporting surface with grooves 39.6x39.6 cm code **GMF1**
- Two back holes for tap and standard pop-up plug

Workings for depth 45:

- Stainless steel worktop surface less than or equal to 150 including working costs code **LMF4**
- Stainless steel worktop surface more than 150 up to 190 including working costs code **LMF5**
- Stainless steel worktop surface more than 190 up to 236 including working costs code **LMF6**
- Supporting surface with grooves 33.6x39.6 cm code **GMF2**
- Two back holes for tap and standard pop-up plug

Accessories

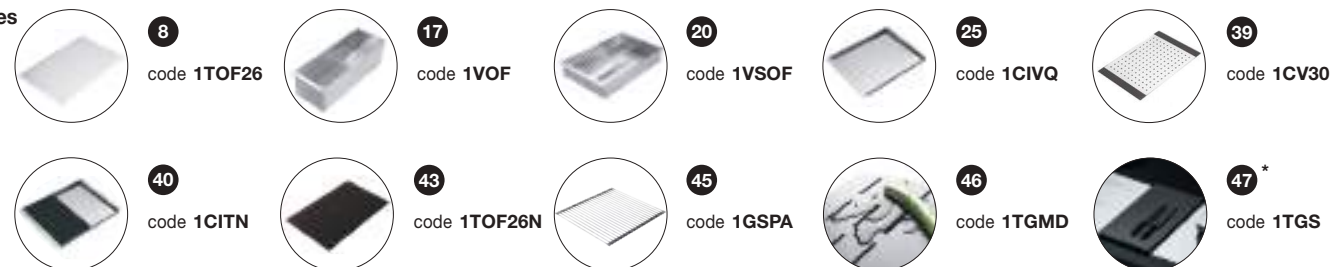

* Accessories for Fusion hob depth 51

MOOD FUSION Examples for price and worktop combination

Composition: stainless steel surface including workings + selected elements

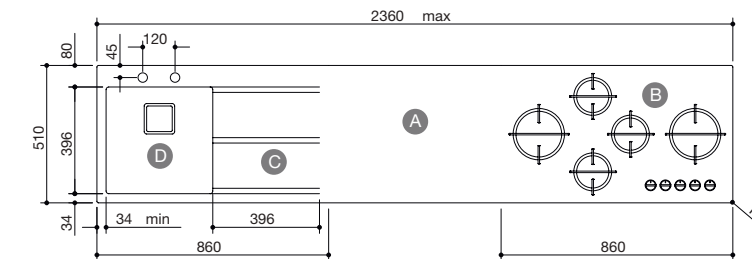

Length 236 Depth 51

- A Stainless steel worktop more than 190 up to 236 including working costs code **LMF3**
- B 90 cm Mood 4 gas burners + Flat Eco-design double ring code **PM95**
- C Supporting surface with grooves 39.6x39.6 code **GMF1**
- D Bowl R. "12" 34x40x20 h code **VQRM34**

- 234x49 cm cut out

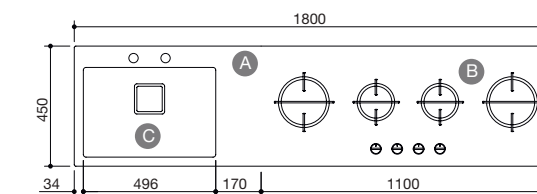

Length 180 Depth 45

- A Stainless steel worktop more than 150 up to 190 including working costs code **LMF5**
- B 110 cm Mood 3 gas burners + Flat Eco-design double ring code **PM104**
- C Bowl R. "12" 50x34x20 h code **VQRM5034**

- 178x43 cm cut out